

Design Data	
Commutation	Brushed
Direction of rotation	Bi-directional
Bearing type	A:Ball - B:Sleeve

Performance data		
Rated voltage [V]	U_N	24
Nominal torque [Nm]	M_N	0.15
No-load speed [min^{-1}]	n_0	2,200.0
Nominal power [W]	P_N	30.9
Nominal current [A]	I_N	2.5
Nominal force [kN]	F_N	0.00
Duty cycle	s1	

Sensor data	
Pulses	0
Output channels	0

Other data	
Gear ratio	
Gear wheel material	
Suppression components	5 μ H
Enclosure class	IP 30
Weight [kg]	0.900

Remarks: 3 start worm

Characteristic curves

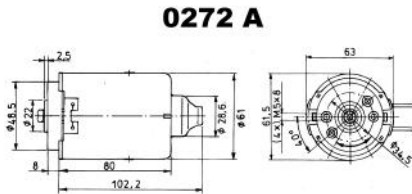

Motor picture

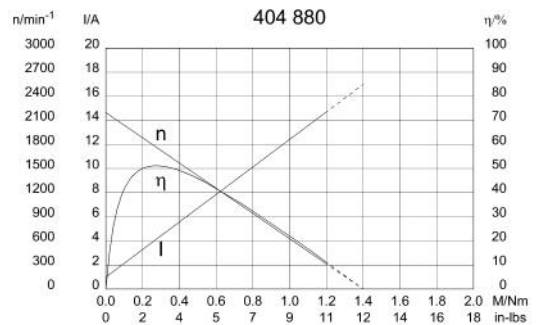
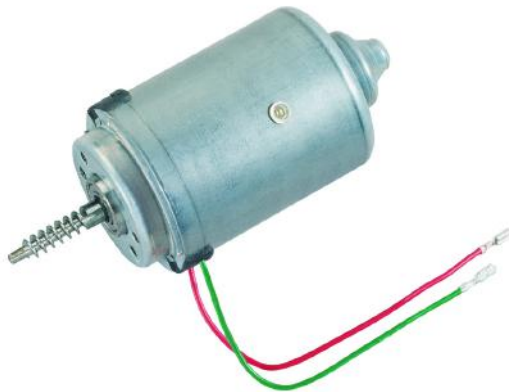

Output shaft drawing (W), Wiring diagrams (S) and Connector layout (K)

W 300

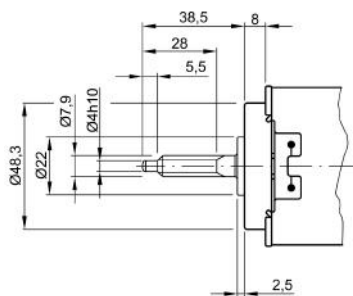

no of starts 3, lead angle 30°33'44", pressure angle 15°, module 1, pitch 3,141 mm (0,124")

S 27

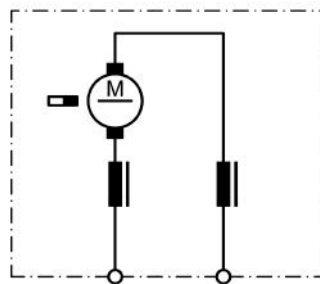

K 264

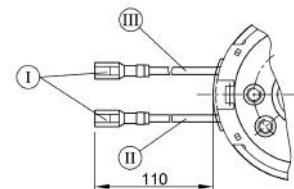

I Receptacle for tabs 2,8 x 0,8 DIN 46 247
 II green
 III red